



Hawthorne Crescent, West Drayton, UB7 9PB

- Ground floor Maisonette
- Two allocated parking bays
- Large storage room
- Available NOW
- Water Bill included
- Large rear private garden
- Furnished
- EPC Rating- D
- Must be seen

£1,375 PCM

Description

Presented to the lettings market this unique one bedroom ground floor maisonette situated in a popular residential area and within a short walk to the train station and high street. Benefits from a landscaped rear garden, two parking bays and a large storage room. Furnished, price inclusive of the water bill and available NOW. Must act quickly.

Ground Floor

Approx. 46.5 sq. metres (500.9 sq. feet)

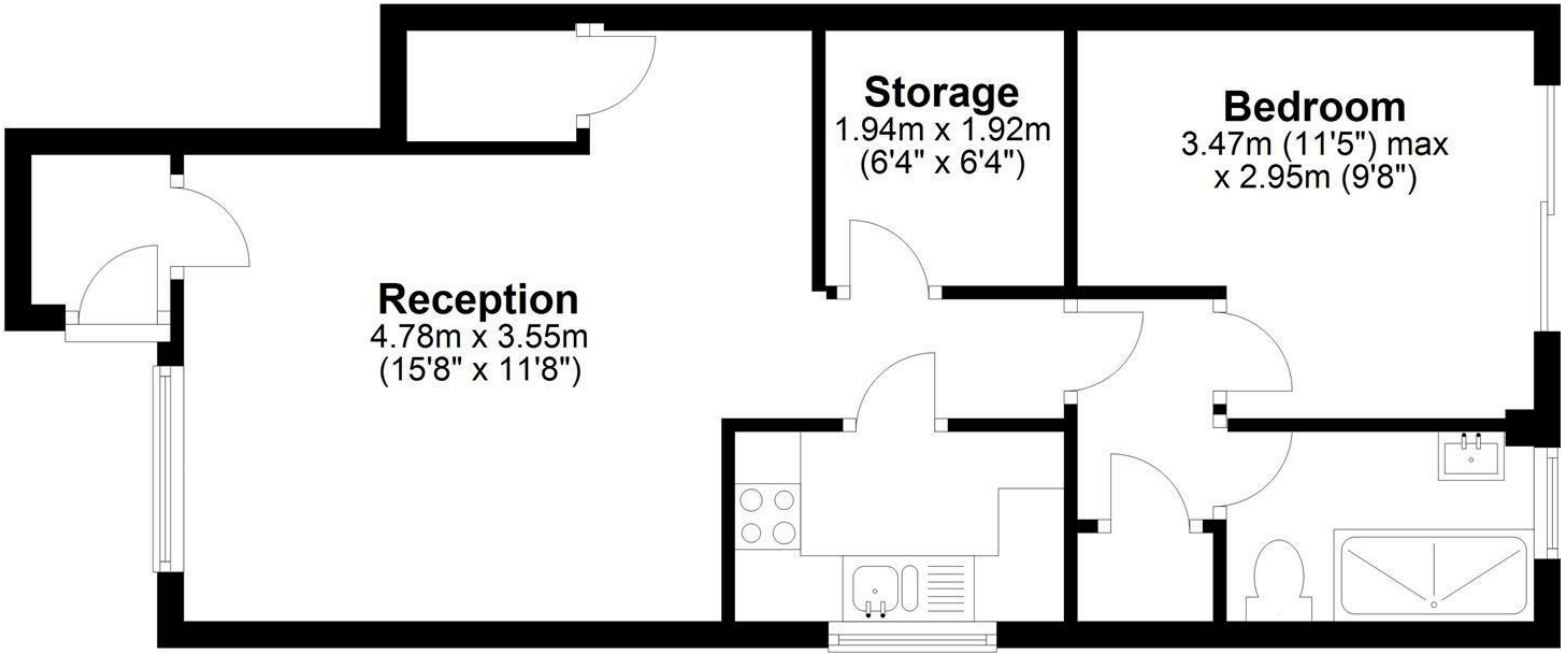

Total area: approx. 46.5 sq. metres (500.9 sq. feet)

IMPORTANT NOTICE

These particulars have been prepared upon information supplied by the Vendor and should be verified by your surveyors and solicitors. We have prepared these sales particulars as a general guide to give a broad description of the property. They are not intended to constitute part of an offer or contract. We have not carried out a structural survey and the services, appliances and specific fittings have not been tested. All photographs, measurements, floor plans and distances referred to are given as a guide only and should not be relied upon for the purchase of carpets or any other fixtures or fittings. Lease details service charge and ground rent (where applicable) are given as a guide only and should be checked and confirmed by your solicitor prior to exchange of contracts